

## Clutch Ring Replacement and Adjustment

This bulletin covers the following Champion Power Equipment models:

C80295	7500LB Winch	C95285	9500LB Winch
C80195	8000LB Winch	C95385	9500LB Winch
10012	8000LB Winch	C10585	10,000LB Winch
10021	8000LB Winch	C10586	10,000LB Winch

Note: Read instructions completely before performing service.

1. Remove phillips head screws that attach the end bearing, on the gear housing side, to the solenoid box. This will allow you to remove the entire gear housing from the rest of the winch.
2. Remove the six phillips head screws from the end cap of the gear housing – place gear housing on end and stack all the gears on the workbench, this will help to easily reassemble.

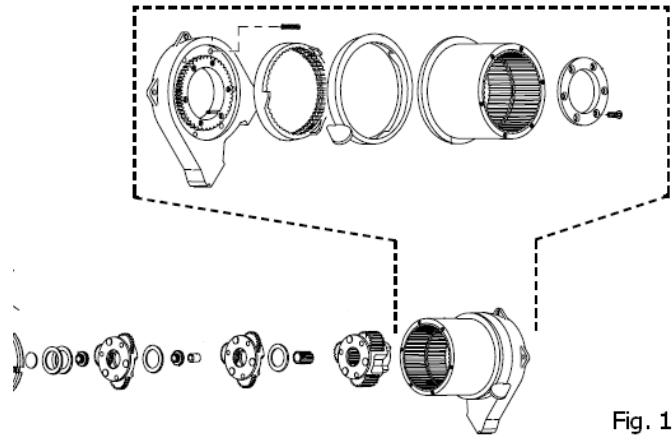

Fig. 1

3. Once the gears, bushings and plate have been removed you will find a black ring, Retainer – Ring Gear held in by six screws with springs. Remove the screws and this will allow the gear housing to be removed from the end bearing.
4. Once the gear housing has been removed you will then be able to make the proper adjustments to your gear ring and clutch ring.
5. Once adjustments or replacement has been done, reinstall the gear housing to the end bearing and reinstall the the Retainer – Ring Gear with the springs and screws. Replace gears in gear housing same as removed, see fig. 1 or refer to parts list to assure gears installed correctly.

If you have any questions, please contact Champion Power Equipment:

Champion Power Equipment, Inc.  
12039 Smith Ave.  
Santa Fe Springs, CA 90670

Phone: 1-877-338-0999

Email: [tech@championpowerequipment.com](mailto:tech@championpowerequipment.com)