

Champion Power Equipment manufactures and sells accessories designed to help you get the most from your purchase. To find out more about our covers, power cables and storm kits, please visit our web site at www.championpowerequipment.com

Parts Included

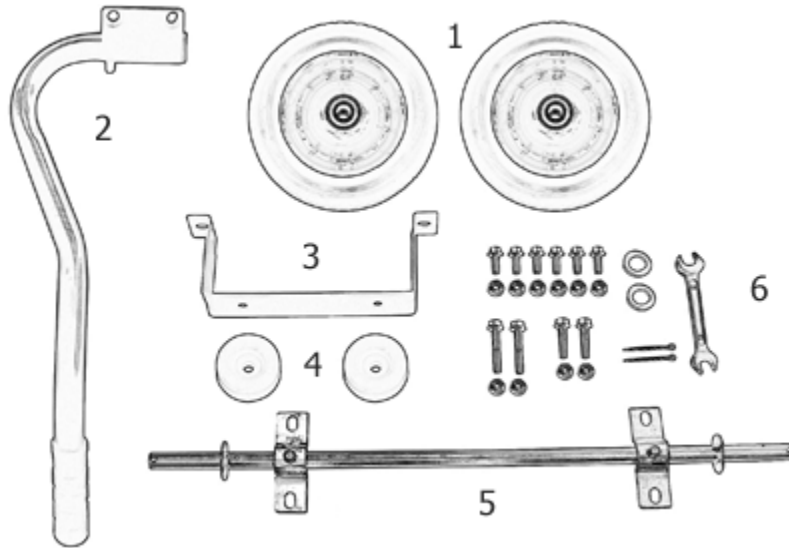

1. Solid Wheel (2)
2. Handle (1)
3. Support Leg (1)
4. Vibration Mounts (2)
5. Axle (1)
6. Hardware Kit
Cap Screws & Nuts (10)
"O" Washers (2)
Cotter Pins (2)

Install the Wheel Kit

You will need the following tools to install the wheels:

- 12 mm wrench
- Socket wrench with a 12 mm socket
- Pliers

1. Locate and remove the 4 rubber vibration mounts on the bottom of the generator frame.
2. Bolt the axle to the frame with four cap screws (M8x20) and lock nuts (M8).

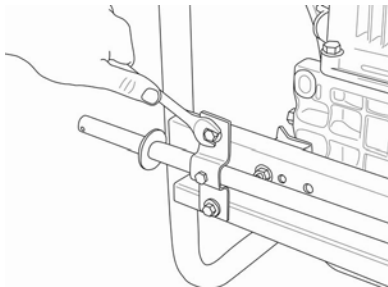

3. Slide a wheel onto the axle.
4. Place a washer on the end.
5. Install the cotter pin through the hole on the end of the axle.

6. Carefully bend the legs of the cotter pin back around the axle.

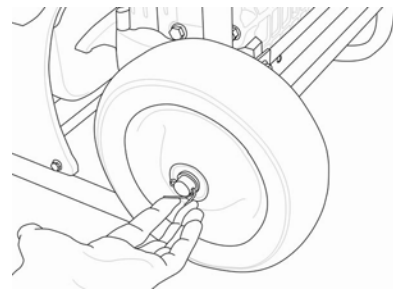

7. Repeat steps 3-6 to attach the second wheel.

Install the Support Leg

1. Attach the rubber vibration mount to the support leg with a cap screw (M8x30) and lock nut (M8).
2. Attach the support leg to the generator frame with cap screws (M8x20) and lock nuts (M8).



Mobility Kit Installation

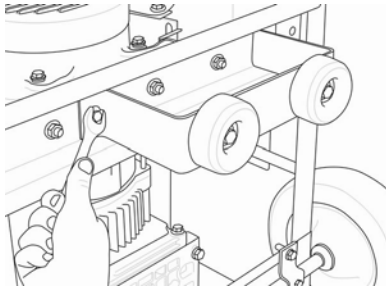

3. Tip the generator slowly so that it rests on the wheels and support leg.

Install the Handle

1. Locate the welded block on the top of the generator frame.
2. Slide the C bracket located at the end of the handle, over the block.

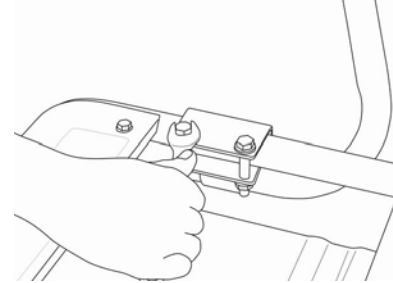

3. Secure with 2 bolts (M8x40) and locknuts (M8).

If you have any questions, please contact Champion Power Equipment:

Champion Power Equipment, Inc.
10006 Santa Fe Springs Rd.
Santa Fe Springs, CA 90670

Phone: (877) 338-0999
Fax: (562) 236-9429
Email: tech@championpowerequipment.com