

# Table of Contents

---

<b>Introduction</b> .....	<b>1</b>	<b>Specifications</b> .....	<b>7</b>
Accessories.....	1	Parts Diagram .....	7
This Booklet.....	1	Parts List .....	8
<b>Manual Conventions</b> .....	<b>2</b>	Dimensions .....	8
<b>Safety Rules</b> .....	<b>3</b>	<b>Warranty</b> .....	<b>9</b>
<b>Controls and Features</b> .....	<b>4</b>	Warranty Qualifications .....	9
Oil Drainer .....	4	Repair/Replacement Warranty .....	9
<b>Assembly</b> .....	<b>5</b>	Do not return the unit to the place of	
Remove from the Shipping Carton .....	5	purchase .....	9
Inspection .....	5	Warranty Exclusions.....	9
Install the Wheels .....	5	Limits of Implied Warranty and	
Install the Casters .....	5	Consequential Damage .....	9
Install the Drain Assembly .....	5	Contact Information .....	9
<b>Operation</b> .....	<b>6</b>	Address .....	9
Oil Drainer Location .....	6	Customer Service .....	9
Draining Oil .....	6	Technical Service.....	9
Evacuating the Tank.....	6	<b>Notes</b> .....	<b>10</b>
Transporting the Tank.....	6		

---



## Introduction

Congratulations on your purchase of a Champion Power Equipment oil drainer. CPE designs and builds shop equipment to strict specifications. With proper use and maintenance, this oil drainer will bring years of satisfying service.

## *This Booklet*

Every effort has been made to ensure the accuracy and completeness of the information in this manual. We reserve the right to change, alter and/or improve the product and this document at any time without prior notice.

## Accessories

Champion Power Equipment manufactures and sells accessories designed to help you get the most from your purchase. To find out more about our products, please visit our web site at

[www.championpowerequipment.com](http://www.championpowerequipment.com)

Record the model number as well as date and place of purchase for future reference. Have this information available when ordering parts and when making technical or warranty inquiries.

<b>Champion Power Equipment Support</b>
(877) 338-0999
<b>Model Number</b>
C18590
<b>Date of Purchase</b>
<b>Purchase Location</b>

# Manual Conventions

---

## Manual Conventions

This manual uses the following symbols to help differentiate between different kinds of information. The safety symbol is used with a key word to alert you to potential hazards in operating and owning power equipment.

Follow all safety messages to avoid or reduce the risk of serious injury or death.

### **DANGER**

DANGER indicates an imminently hazardous situation which, if not avoided, *will* result in death or serious injury.

### **WARNING**

WARNING indicates a potentially hazardous situation which, if not avoided, *could* result in death or serious injury.

### **CAUTION**

CAUTION indicates a potentially hazardous situation which, if not avoided, *may* result in minor or moderate injury.

### **CAUTION**

CAUTION used without the safety alert symbol indicates a potentially hazardous situation which, if not avoided, *may* result in property damage.

### **NOTE**

If you have questions regarding your tear down table, we can help. Please call our help line at (877) 338-0999.

# Safety Rules

## Safety Rules

### **DANGER**

DO NOT leave the oil drainer unattended when operating or evacuating.

This device dispenses fluids using pressurized air and complies with the specifications of the Uniform Code, Standard Fire Prevention Code and the Nation Fire Protection Association (NFIPA-30). It does not comply with current provisions of BOCA Section F-3203.5.3. Please consult your local fire authority concerning compliance with local codes and ordinances.

### **DANGER**

DO NOT use the oil drainer for handling highly volatile fuels and liquids.

### **DANGER**

DO NOT use near an open flame or heat source.

### **CAUTION**

DO NOT pressurize the tank with the ball valve open.

If tank does not evacuate upon pressurization, confirm that the ball valve is fully closed. Remove the oil drainer from service immediately if the pressure release valve relieves any pressure from the tank.

The pop-off valve and non-adjustable regulator have been installed for your protection. Do not tamper with these safety features.

### **CAUTION**

Always disconnect air supply after evacuation.

### **CAUTION**

Use only the nozzle assembly provided or a factory authorized spare.

### **CAUTION**

Always raise the drain bowl and close the main valve before evacuation.

## Controls and Features

---

### Controls and Features

Read this owner's manual before using your oil drainer. Familiarize yourself with the location and function of the oil drainer's features. Save this manual for future reference.

#### *Oil Drainer*

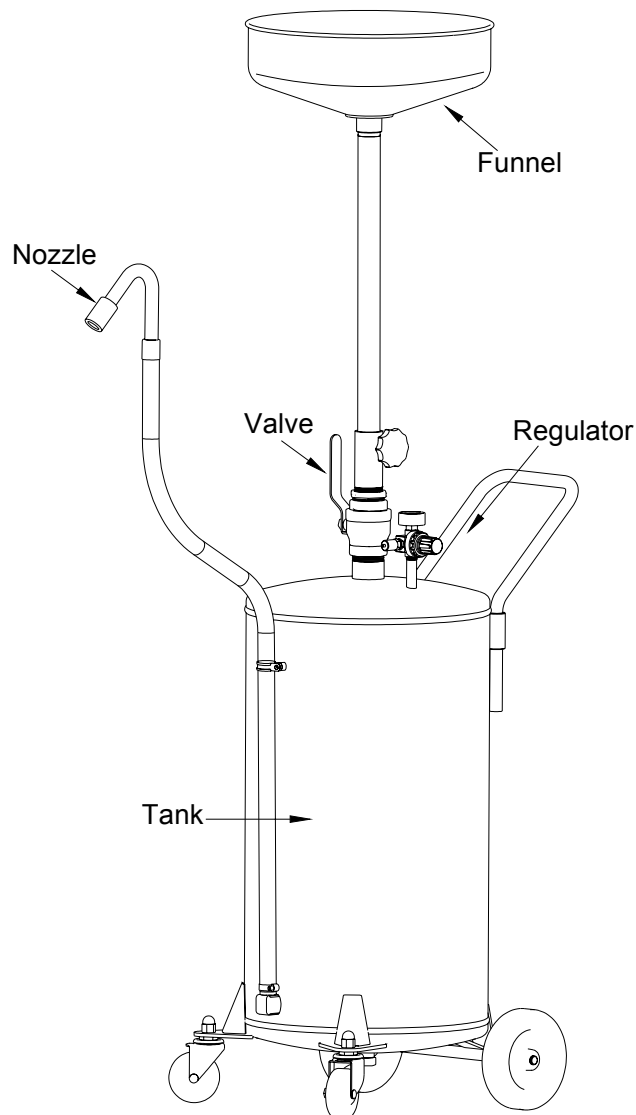

**Funnel** – large capacity

**Nozzle**– hooked nozzle for oil evacuation

**Regulator** – non-adjustable pressure regulator

**Tank** – 18 Gallon capacity tank

**Valve** – Sealed ball valve

## Assembly

Your oil drainer requires some assembly. All bolts and screws must be properly tightened before use.

If you have any questions regarding the assembly of your oil drainer, call our help line at (877) 338-0999. Please have your model number and proof of purchase available.

## Remove from the Shipping Carton

1. Set the shipping carton on a solid, flat surface.
2. Remove everything from the carton.
3. Carefully cut each corner of the box from top to bottom. Fold each side flat on the ground to provide a surface area to assemble the oil drainer.

## Inspection

Prior to assembly, operation or maintenance, a visual inspection should be performed. Check for wear, air leaks, and damaged, loose or missing parts. An annual tank and component inspection is recommended to be performed by a CPE authorized service center.

## Install the Wheels

1. Slide the 1/2" diameter steel axle through the axle housing on the bottom of the tank.
2. Place a wheel on the axle and secure with a pal nut.
3. Repeat step 2 for the other wheel.
4. Snap on the hubcaps.

## Install the Casters

1. Remove the wood spacers from the caster brackets.
2. Slide the caster bolt through the bracket and secure with the washer, lock washer and nut.
3. Repeat step 2 for the other caster.

## Install the Drain Assembly

1. Apply TFE pipe sealant on the threads of the 3/4" NPT street ell and screw into the lower fitting on the side of the tank.
2. Slide the worm gear hose clamp over the end of the hose.
3. Tighten firmly.
4. Place loop clamp around tubing and fasten to bracket with 1/4-20-1/2 cap screw, continually keeping tension on the hose to keep it as straight as possible.
5. Apply TFE pipe sealant on the 1 1/2" NNT nipple on top dome of tank.
6. Screw hex bushing into ball valve and 4" pipe nipple into the hex bushing.
7. Screw clamping knob into the 4" pipe nipple.



### NOTE

Only one of the four holes in the 4" nipple is threaded. The other three holes are non-threaded pressure relief ports.

8. Apply TFE pipe sealant on the red funnel adapter bushing and screw into bushing/funnel assembly.
9. Slide drain tube/funnel assembly into tank through the 4" nipple and ball valve assembly.
10. Tighten all fittings to prevent any leaking.
11. Position catch spring down into the drain within the funnel assembly.

# Operation

---

## Operation

### *Oil Drainer Location*

Place the oil drainer on a flat, level surface. Lock the casters to prevent movement. For added stability, use wheel chocks (not included).

Check tank operation by connecting air to the inlet nipple and closing the ball valve. Verify that there is sufficient air flow coming from the nozzle/hose assembly.

### *Draining Oil*

With the valve fully open (valve handle in vertical position), raise the drain bowl to the desired height and lock into place. Drain oil into bowl/tank assembly. Check sight gauge tube on back side of tank frequently.

## CAUTION

DO NOT fill tank above the maximum oil level.

### *Evacuating the Tank*

Raise drain bowl and lock into place. Completely close the ball valve (valve handle in horizontal position). Place nozzle securely into used oil collection reservoir. Connect air to the inlet nipple and discharge oil. Immediately disconnect the air supply when oil is no longer discharging into the reservoir.

### *Transporting the Tank*

With the valve fully open (valve handle in vertical position), lower drain bowl to desired height. Always use the tank handle to transport the oil drainer.

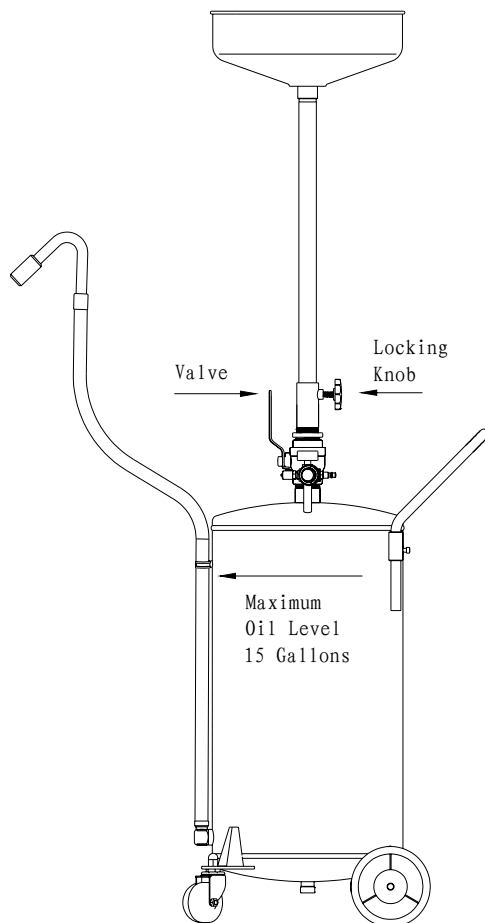



## Specifications

### Parts Diagram

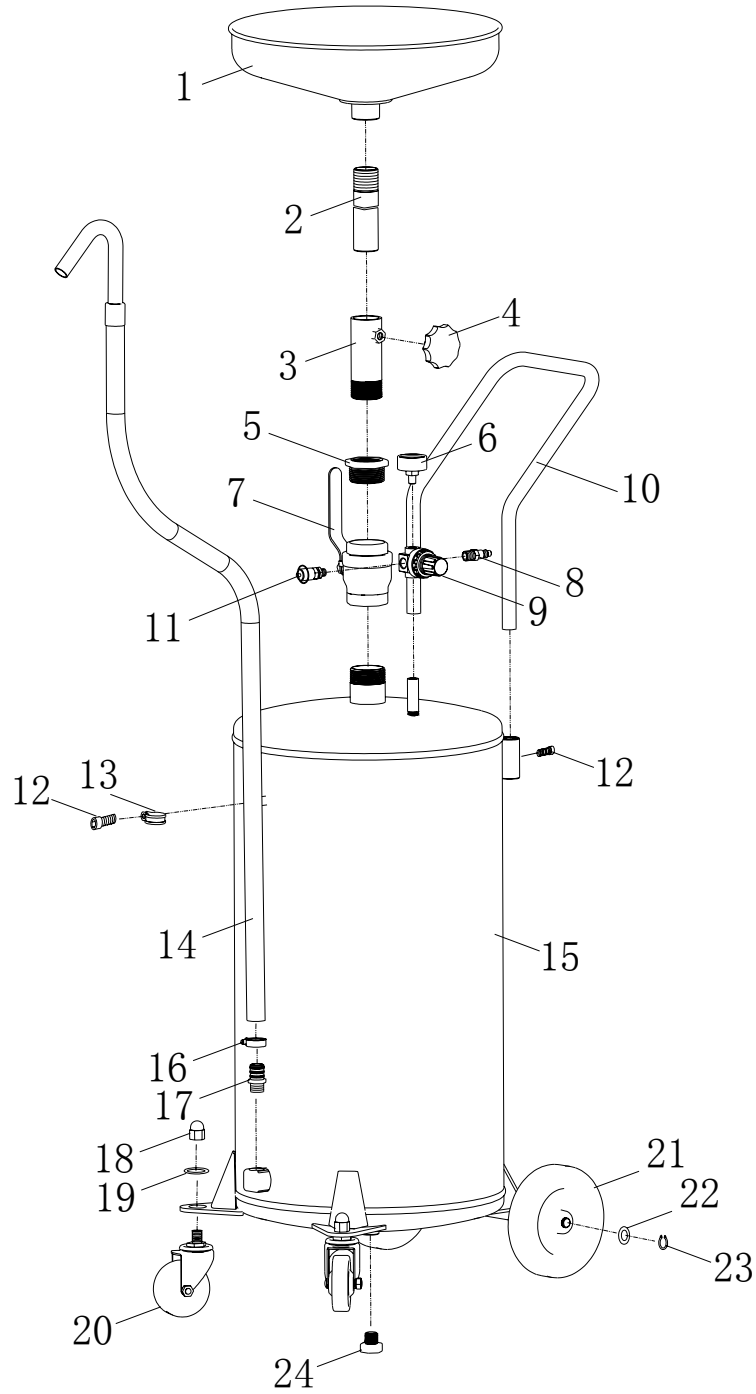

# Specifications

---

## Parts List

No	Part #	Description	Qty
1	P18590-1	Funnel Assembly	1
2	P18590-2	Drain Tube	1
3	P18590-3	4" Nipple	1
4	P18590-4	Knob	1
5	P18590-5	Hex Bushing	1
6	P18590-6	Pressure Gauge	1
7	P18590-7	Ball Valve	1
8	P18590-8	Tube Connector	1
9	P18590-9	Regulator	1
10	P18590-10	Handle	1
11	P18590-11	Bleeding Valve	1
12	P18590-12	Screw	3
13	P18590-13	Loop Clamp	1
14	P18590-14	Hose/Nozzle Assembly	1
15	P18590-15	Tank Assembly	1
16	P18590-16	Loop Clamp	2
17	P18590-17	Barbed Fitting	1
18	P18590-18	Nut	2
19	P18590-19	Washer	2
20	P18590-20	Caster	2
21	P18590-21	Wheel	2
22	P18590-22	Washer	4
23	P18590-23	Retaining Ring	2
24	P18590-24	Screw Plug	1

## Dimensions

Height	46 "
Height with bowl extended	76"
Bowl Depth	5 1/2"
Bowl Diameter	15"
Tank Capacity	18 Gal

## Warranty

CHAMPION POWER EQUIPMENT  
1 YEAR LIMITED WARRANTY

### Warranty Qualifications

Champion Power Equipment (CPE) will register this warranty upon receipt of your Warranty Registration Card and a copy of your sales receipt from one of CPE's retail locations as proof of purchase.

Please submit your warranty registration and your proof of purchase within ten (10) days of the date of purchase.

### Repair/Replacement Warranty

CPE warrants to the original purchaser that the mechanical components will be free of defects in material and workmanship for a period of one (1) year from the original date of purchase (90 days for commercial & industrial use). This warranty only applies to the original purchaser and is not transferable.

### Do not return the unit to the place of purchase

Contact CPE's Technical Service and CPE will troubleshoot any issue via phone or e-mail. If the problem is not corrected by this method, CPE will, at its option, authorize evaluation, repair or replacement of the defective part or component at a CPE Service Center. CPE will provide you with a case number for warranty service. Please keep it for future reference. Repairs or replacements without prior authorization, or at an unauthorized repair facility, will not be covered by this warranty.

### Warranty Exclusions

This warranty will not apply to parts and/or labor if this oil drainer is deemed to have been misused, neglected, involved in an accident, abused, overfilled, modified, or assembled improperly. Cosmetic defects such as paint, decals, etc., are excluded from this warranty. \*Warranty is Limited to 90-days from purchase for Commercial use, including Rentals.

### Limits of Implied Warranty and Consequential Damage

Champion Power Equipment disclaims any obligation to cover any loss of time, use of this product, freight, or any incidental or consequential claim by anyone from using this oil drainer. THIS WARRANTY IS IN LIEU OF ALL OTHER WARRANTIES, EXPRESS OR IMPLIED, INCLUDING WARRANTIES OF MERCHANTABILITY OR FITNESS FOR A PARTICULAR PURPOSE

A unit provided as an exchange will be subject to the warranty of the original unit. The length of the warranty governing the exchanged unit will remain calculated by reference to the purchase date of the original unit.

This warranty gives you certain legal rights which may change from state to state. Your state may also have other rights you may be entitled to that are not listed within this warranty.

### Contact Information

#### Address

Champion Power Equipment, Inc.  
Customer Service  
10006 Santa Fe Springs Rd.  
Santa Fe Springs, CA 90670

#### Customer Service

Mon – Fri 8:30 AM – 5:00 PM (PST/PDT)  
Toll Free: 1-877-338-0999  
Fax no.: 1-562-236-9429

#### Technical Service

Mon – Fri 8:30 AM – 5:00 PM (PST/PDT)  
Toll Free: 1-877-338-0999  
24 hr. Voicemail: 1-626-230-5248 or email:  
tech@championpowerequipment.com

## **Notes**

---

## **Notes**