



OWNER'S MANUAL & OPERATING INSTRUCTIONS



BIKE CARRIER



MODEL NUMBER
100189

SAVE THESE INSTRUCTIONS
Important Safety Instructions
are included in this manual.

MADE IN CHINA
REV 100189-20160225

12039 Smith Ave.
Santa Fe Springs CA 90670
USA / 1-877-338-0999
www.championpowerequipment.com

Have questions or need assistance?

Do not return this product to the store!

WE ARE HERE TO HELP!

Visit our website:

www.championpowerequipment.com

for more info:

- Product Info & Updates
- Tech Bulletins
- Frequently Asked Questions
- Product Registration

– or –

Call our Customer Care Team Toll-Free at:

1-877-338-0999

Parts Ordering:

Mon – Fri 8:30 AM – 5:00 PM (PST/PDT)

Toll Free: 1-877-338-0999

*We are always working to improve our products. Therefore, the enclosed product may differ slightly from the image on the cover.

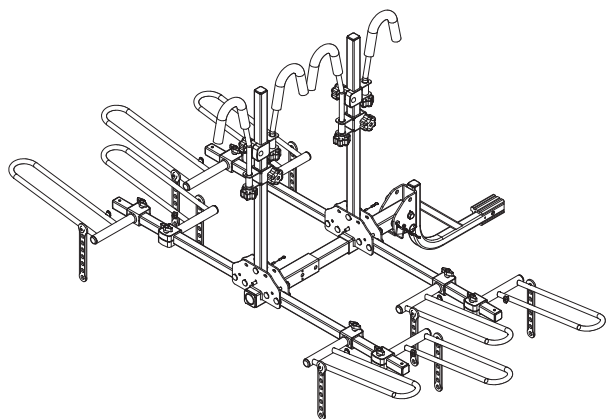

BIKE CARRIER

TABLE OF CONTENTS

Introduction	4
Introduction	4
Manual Conventions	5
Safety Rules	6
Controls and Features	7
Bike Carrier	7
Parts Included	8
Assembly	9
Assembling the Bike Carrier	9
Mounting the bikes	11
Tilt Down Feature	12
Travel/Storage Feature	12
Parts Diagram	14
Parts List	15

INTRODUCTION

Introduction

Congratulations on your purchase of a Champion Power Equipment product. Champion Power Equipment and Champion Engine Technology designs, builds, and supports all of our products to strict specifications and guidelines. With proper product knowledge, safe use, and regular maintenance, this product should bring years of satisfying service.

Every effort has been made to ensure the accuracy and completeness of the information in this manual, and we reserve the right to change, alter and/or improve the product and this document at any time without prior notice.

Since CPE/CET highly value how our products are designed, manufactured, operated and are serviced, and also highly value your safety and the safety of others, we would like you to take the time to review this product manual and other product materials thoroughly and be fully aware and knowledgeable of the assembly, operation, dangers and maintenance of the product before use. Fully familiarize yourself, and make sure others who plan on operating the product fully familiarize themselves too, with the proper safety and operation procedures before each use. Please always exercise common sense and always error on the side of caution when operating the product to ensure no accidents, property damage, or injury occurs. We want you to continue to use and be satisfied with your CPE/CET product for years to come.

Record the model and serial numbers as well as date and place of purchase for future reference. Have this information available when ordering parts and when making technical or warranty inquiries.

Champion Power Equipment Support
1-877-338-0999
Model Number
100189
Date of Purchase
Purchase Location

This manual uses the following symbols to help differentiate between different kinds of information. The safety symbol is used with a key word to alert you to potential hazards in operating and owning power equipment.

Follow all safety messages to avoid or reduce the risk of serious injury or death.

 **DANGER**

DANGER indicates an imminently hazardous situation which, if not avoided, **will** result in death or serious injury.

 **WARNING**

WARNING indicates a potentially hazardous situation which, if not avoided, **could** result in death or serious injury.

 **CAUTION**

CAUTION indicates a potentially hazardous situation which, if not avoided, **may** result in minor or moderate injury.

CAUTION

CAUTION used without the safety alert symbol indicates a potentially hazardous situation which, if not avoided, **may** result in property damage.

 **NOTE**

If you have questions regarding your bike carrier, we can help. Please call our help line at **1-877-338-0999**.

SAFETY RULES

WARNING

Read this manual thoroughly before installing and using your bike carrier. Failure to follow instructions could result in serious injury to person or property.

WARNING

This rack is designed to attach securely to most automobile receiver hitches. Due to variations in automobile design and utility, we cannot guarantee this product will fit all vehicles. It is your responsibility to ensure the safe and proper use of this product.

This rack is designed for use on passenger cars, trucks and SUVs with appropriate receiver capacity. Improper use and attachment of the rack to your vehicle may be hazardous to your bicycles, vehicles or other vehicles driving behind you.

WARNING

The bicycle carrier should not be used for TOWING or any pulling purpose. Not for use behind a 5th wheel, travel trailer, or motor home.

CAUTION

ALWAYS secure your bicycles to the rack using the frame cradles and straps. Additional rope, shock cords, or cable locks may be used for additional security and stability.

If a strap appears worn or frayed, replace it immediately.

Check straps and cradles regularly during use. It's a good practice to stop your vehicle after 152 m (500 ft.) and check the security of the mounted bicycles.

This bike carrier was not constructed to protect bicycles from severe abuse in off-highway driving conditions. Bumpy roads may cause mounted bicycles to move and shift in transit, resulting in property damage.

DO NOT let bicycle tires hang near the exhaust pipe of your vehicle. Hot exhaust may cause damage to tires.

WARNING

DO NOT exceed the rated capacity of this bike carrier. Load no more than 4 bicycles, weighing less than 68 kg (150 lb.) total.

DO NOT use this bike carrier for transporting or carrying other items or materials besides bicycles.



Not for use on the back of trailers and motor homes, or on off-road terrain.

Read this owner's manual before using your bike rack. Familiarize yourself with the location and function of the controls and features. Save this manual for future reference.

Bike Carrier

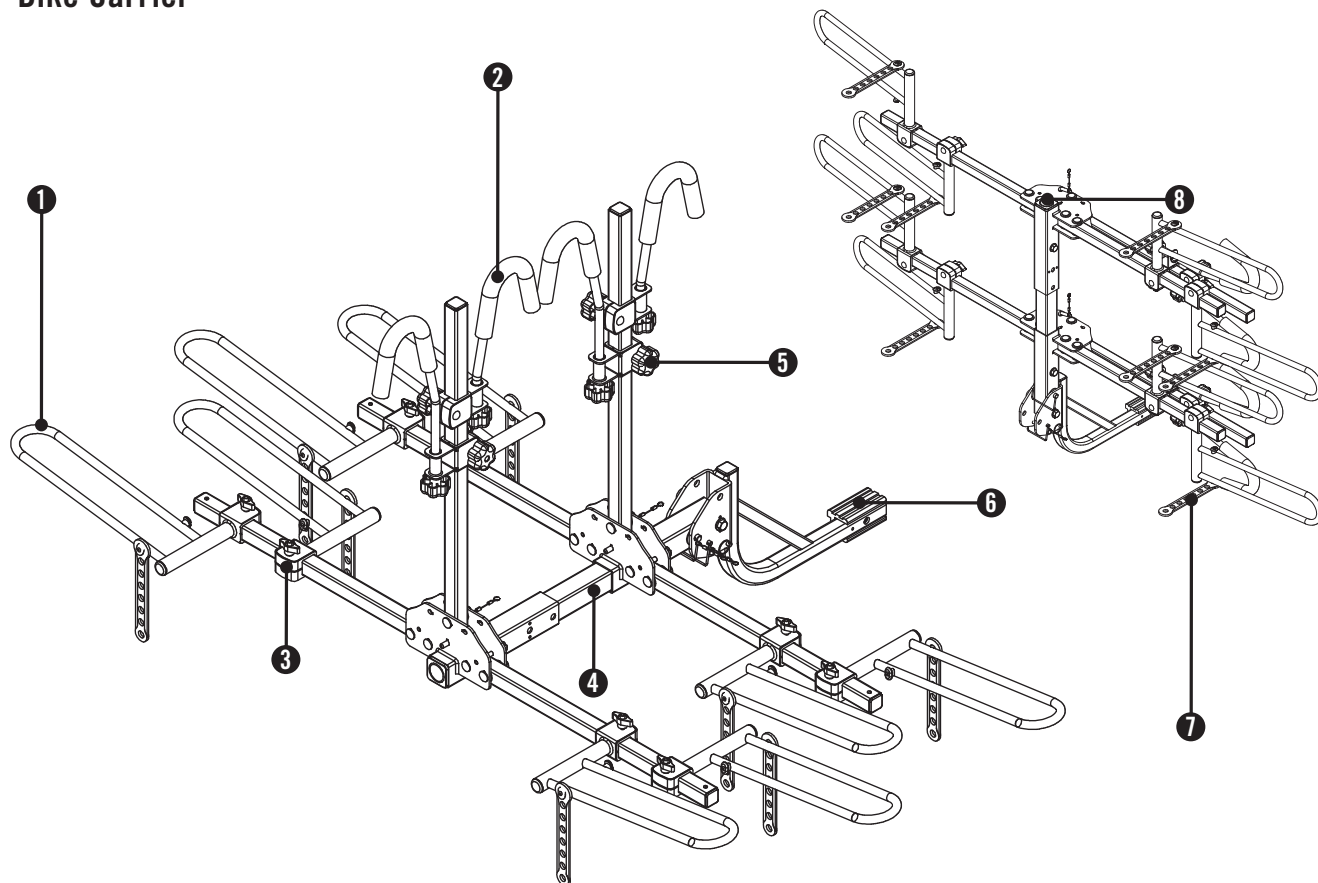

- | | |
|--|--|
| <p>(1) Cradle – Used to support wheels.</p> <p>(2) Hooks – Used to secure bike frame.</p> <p>(3) Wing nut – Used to slide arms in place to fit wheels.</p> <p>(4) Extension tube – Used to convert from a 2 to a 4 bike carrier.</p> | <p>(5) Plastic knob – Used to adjust height of hooks.</p> <p>(6) 5.1 cm (2 in.) Adapter – Used to adapt 3.2 cm (1.25 in.) hitches to 5.1 cm (2 in.)</p> <p>(7) Wheel straps – Used to secure wheels on the cradles.</p> <p>(8) Reflector</p> |
|--|--|

CONTROLS AND FEATURES

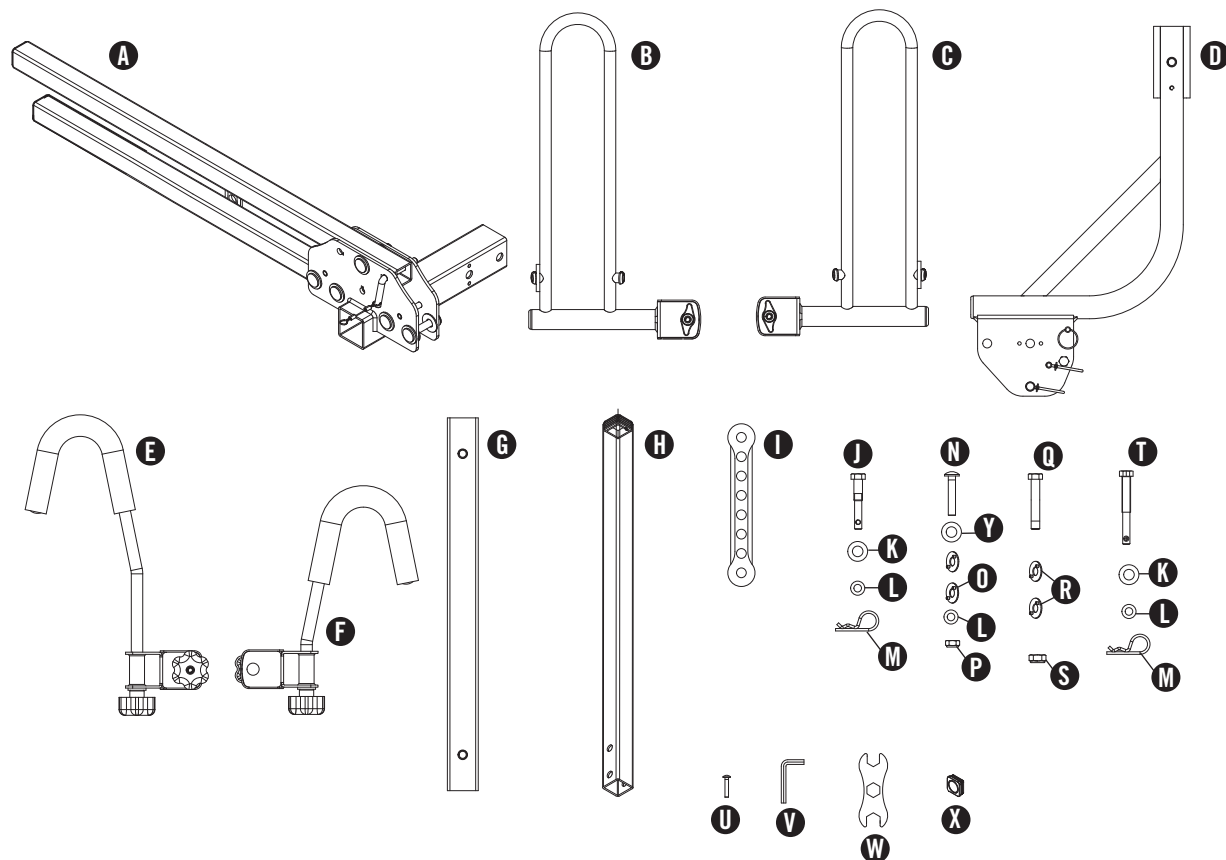

Parts included

Your 100189 bike carrier ships with the following parts:

Assembly parts	QTY.	Assembly parts	QTY.
A. Support base assembly	2	N. Cap screw M10x60	4
B. Left cradle assembly	4	O. Plastic spacer $\varnothing 15 \times \varnothing 28$	8
C. Right cradle arm assembly	4	P. Lock nut M10.	4
D. Hitch mounting shank assembly	1	Q. Screw M12 x 80	1
E. Long J-hook assembly	2	R. Plastic spacer $\varnothing 15 \times \varnothing 36$	4
F. Short J-hook assembly.	2	S. Lock nut M12.	1
G. Extension tube	1	T. Screw M12 x 95 with end hole	1
H. Horizontal tube	2	U. Screw M6 x 10	4
I. Strap.	8	V. Allen wrench M5.	1
J. Screw M12 x 70 with end hole	2	W. Metric wrench 17-18-19.	2
K. Flat washer $\varnothing 13$	3	X. Reflector	2
L. Flat washer $\varnothing 10$	7	Y. Flat washer $\varnothing 15 \times \varnothing 28$	4
M. R-pin.	3		

Assembling the Bike Carrier

NOTE

Remove hardware already in the support base prior to any assembly or inserting tube.

NOTE

Grease can be applied to the plastic spacers if needed for grip upon reinsertion of hardware and tube.

Assemble the primary (1-2 bike) frame, by taking the support base assembly (A) and connecting the horizontal tube (H) using two cap screws (N), lock nuts (P), flat washers (L), and four plastic spacers (O). Make sure the bolt on the end of the horizontal tube is facing up. Be sure to re-insert the two (2) plastic spacers inside of support base before inserting square horizontal tube. Align two small pins into the holes provided.

NOTE

1. The primary support base frame will NOT have a reflector at the end of the tube.

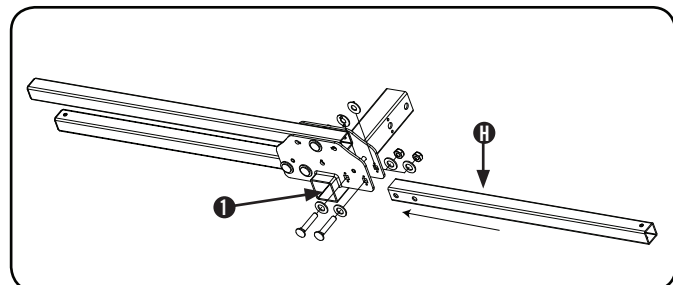

Attach the primary (1-2 bike) support base assembly to hitch mounting assembly (D). Be sure to insert plastic spacers (R) into square tube before attaching to hitch mounting assembly using screw M12x80 (Q) and lock nut M12 (S). Use metal strap and pin $\varnothing 8 \times 85$ mm and pin $\varnothing 12.6 \times 8$ mm for extra safety.

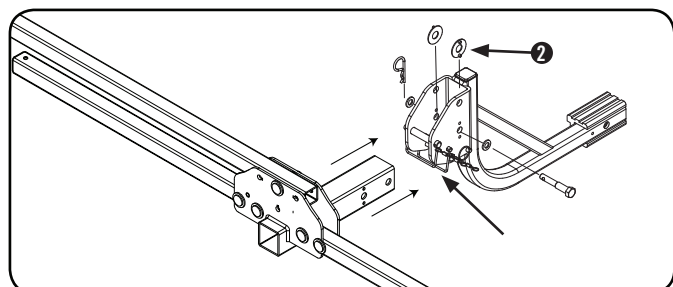

Assembling the bike carrier cont'd.

NOTE

2. Insert plastic spacers (2) onto each side of square tube prior to assembly to hitch mounting assembly.

Make sure the centre bar is in the upright and locked position. Slide the notched key slide into the centre hole and turn to ensure it's locked. Using your hand or a phillips head screw driver (not included), unscrew the bolt on the ends of the horizontal tubes.

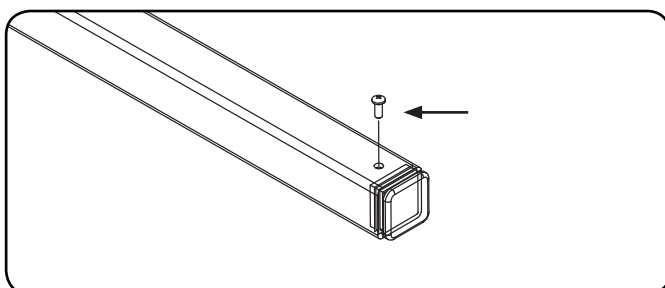
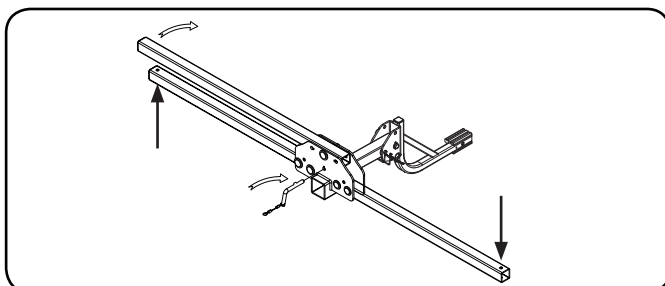

Slide the wheel cradles (B+C) onto the horizontal tubes (A+H). Adjustment knob should be facing up. Loop end of cradle should be facing outward and upward. Insert cradles in sequence as shown below. After all 4 cradles are on the horizontal tubes, replace the end bolts and tighten using a phillips head screwdriver (not included).

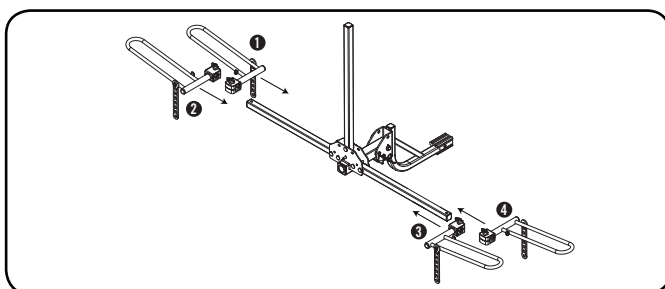

ASSEMBLY

Assembling the bike carrier cont'd.

Install long J-hook assembly (E) and short J-hook assembly (F) onto the centre bar. Twist the side knobs to untighten/tighten and allow the J-hooks to slide up and down the centre bar.

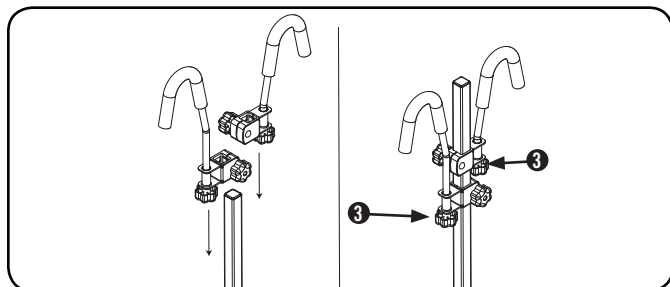

NOTE

3. When tightening "J-hooks" make sure there is no gap in the bottom adjuster. The bottom knob adjuster is "spring" loaded and must be tightened all the way to ensure safety.

WARNING

J-hooks must NOT slide all the way down on the centre bar. This will prevent the bar from going all the way down on either side and locking for proper storage.

If only using the primary (1-2) bike frame, ensure a reflector (X) is inserted firmly into the hollow end before street/road use. Do not insert if using the 3-4 bike frame.

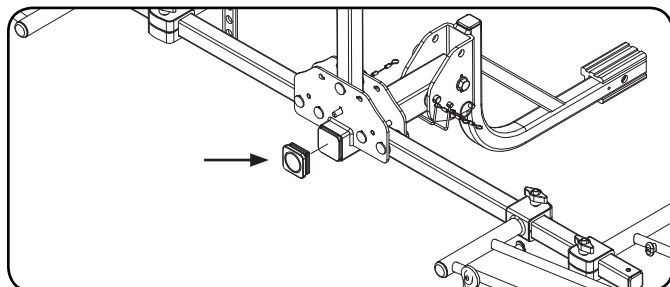

If transporting 3 or 4 bicycles, build the secondary bike frame the same as the primary (1-2) bike frame. Then attach the secondary bike frame assembly to the main hitch assembly using the extension tube (G).

Assembling the bike carrier cont'd.

First attach the extension tube (G) to the primary bike frame, using screw M12x70 with end hole (J), flat washer Ø13, flat washer Ø10 (K, L) & R-pin (M).

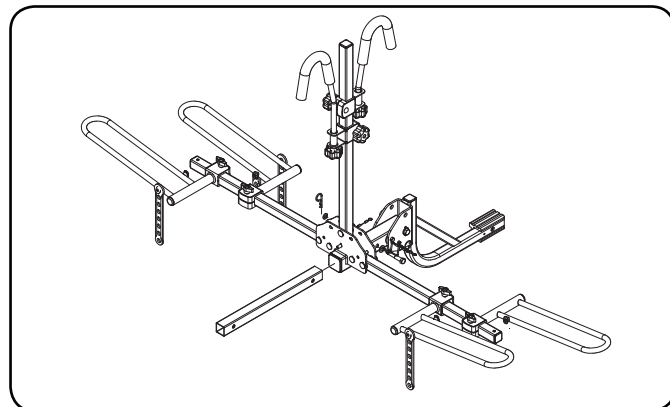

Then attach the secondary frame to the extension tube using the plastic spacers (R) into square tube before threading through screw M12x70 with end hole (J) flat washer Ø13, flat washer Ø10 (K, L) & R-pin (M). Tighten securely.

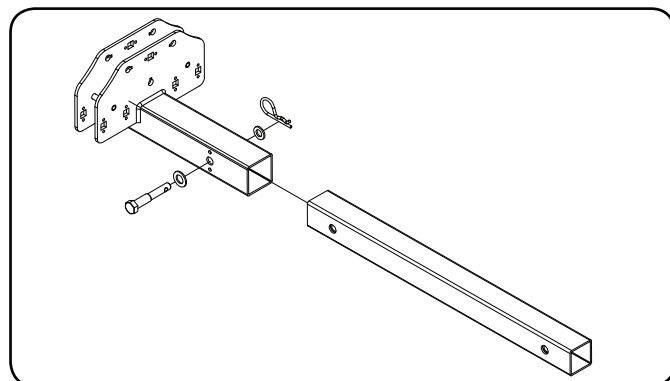
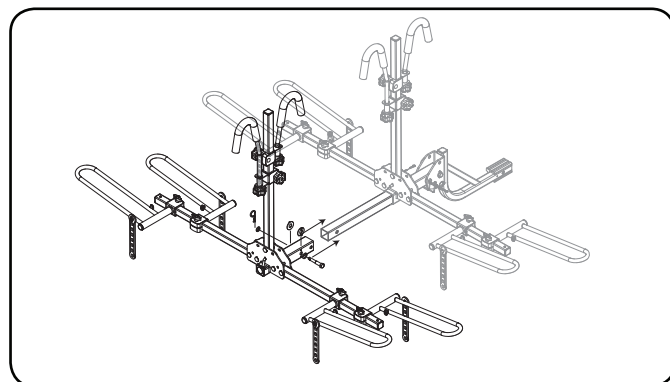

Mounting the Bike Carrier

NOTE

Remove any debris to ensure no blockage is in the receiver.

If you are mounting to a 3.6 cm (1 1/4 in.) receiver hitch, remove the hex socket screw connecting the 5.1 cm (2 in.) receiver adapter, with the allen wrench provided.

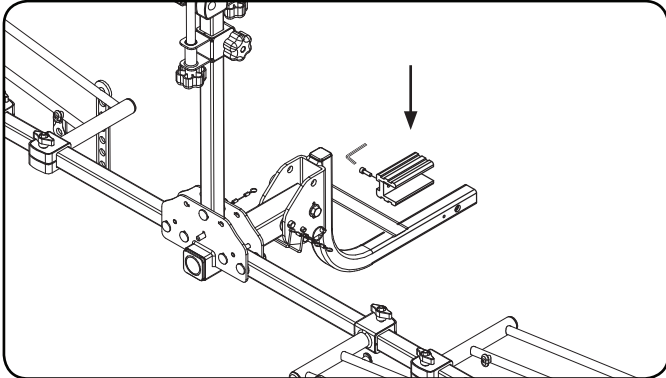

After removal of the 5.1 cm (2 in.) receiver adapter, connect the bike carrier using the screw M12x95 mm with end hole and washers and R-Pin.

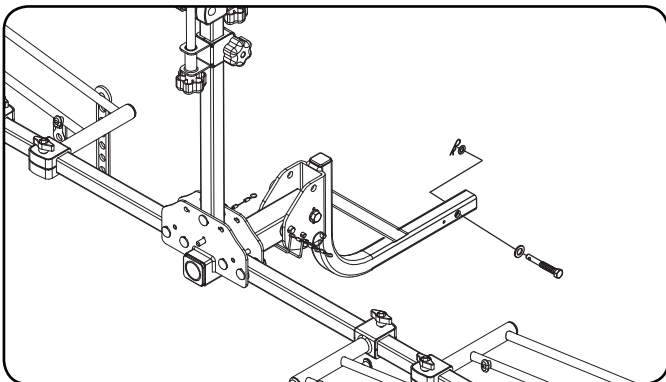

If you are mounting to a 5.1 cm (2 in.) receiver then mount the bike carrier using the using the 5.1 cm (2 in.) receiver adapter, screw M12x95 mm with end hole and washers and R-Pin.

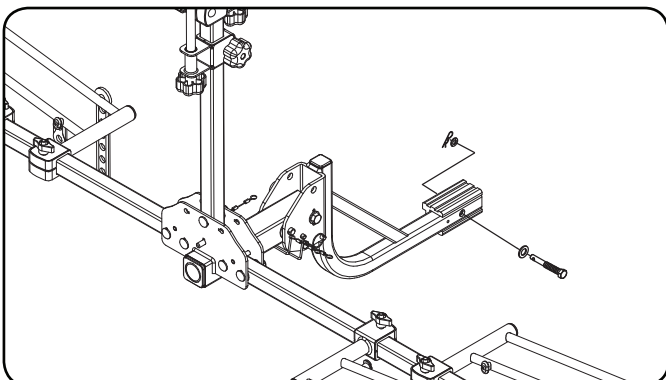

Mounting the bikes

The wheel cradles and J-hooks are completely adjustable and slide on the tubes. Using the vertical knobs on the tops of the cradles and the horizontal knobs on the J-hooks, twist them until they are loose and the cradle or J-hook can move on the tube.

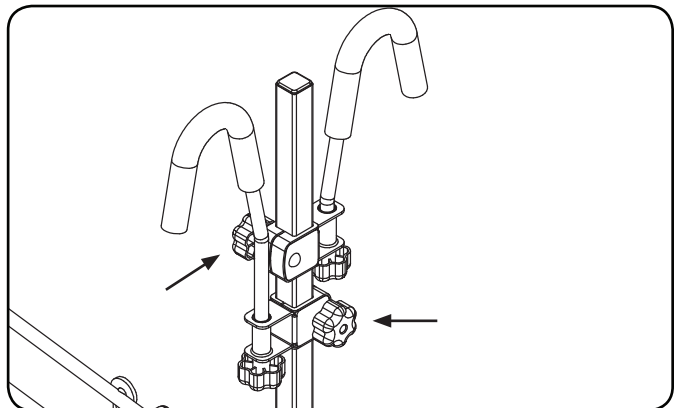
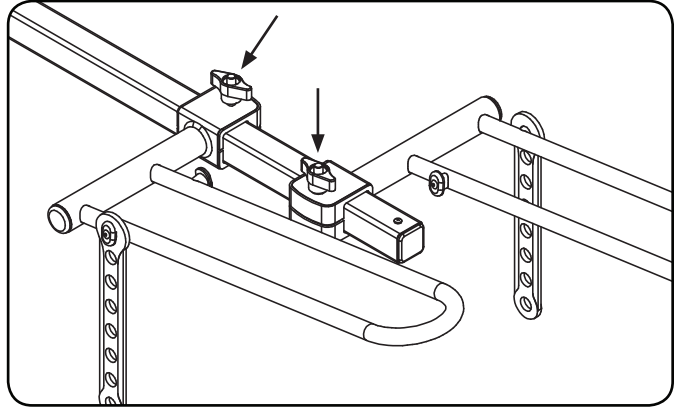

Once adjusted to allow the bike to properly fit into the cradles, load the bike wheels directly into the cradles and ensure they will not roll back and forth. Bring down the J-hook till it is snugly fit over the middle part of the frame on the bike. Twist the side knob to secure the position of the J-hook. Use the strap on the cradles to secure the wheels. Adjust the strap as needed per each wheel. Make sure all wheels have a strap securing them.

NOTE

Drive for a short amount, stop inspect that the bikes are still securely mounted. Always inspect all mounting hardware before use or mounting.

MOUNTING

Tilt Down Feature

For access to the rear of vehicle, with the bikes removed from the rack, securely grasp bike rack, remove main locking pin (through centre of tube) (A), while continuing to grasp the rack, remove the back-up pin (under main bar) (B), and allow the rack to tilt downward. DO NOT drop or allow the rack to be unsupported while the pins are out, this may damage the rack and/or cause injury.

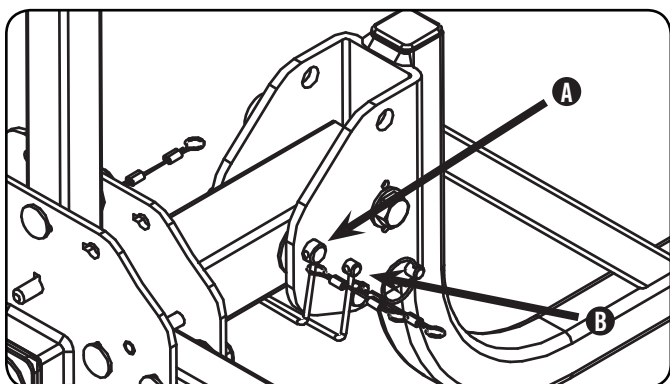

⚠ WARNING

DO NOT attempt to pull out the main locking pin or back-up locking pin while there are bikes mounted to the carrier.

⚠ CAUTION

When traveling, the bike carrier must be locked in the horizontal or upright position. DO NOT operate the vehicle if the carrier is not locked into place.

⚠ WARNING

Failure to properly insert and twist locking pin can cause damage to bikes, vehicles and possibly cause injury.

Travel / Storage Feature

When traveling without bicycles, the bike carrier can fold in the upright position. With the bikes removed from the rack, twist and remove the locking pin from the centre hole. Fold the main centre bar to horizontal position (down on either side) and re-secure using locking pin. Securely grasp bike rack, remove main locking pin (through centre of tube), lift the rack to the upright position and re-secure locking pin to hold in upright position.

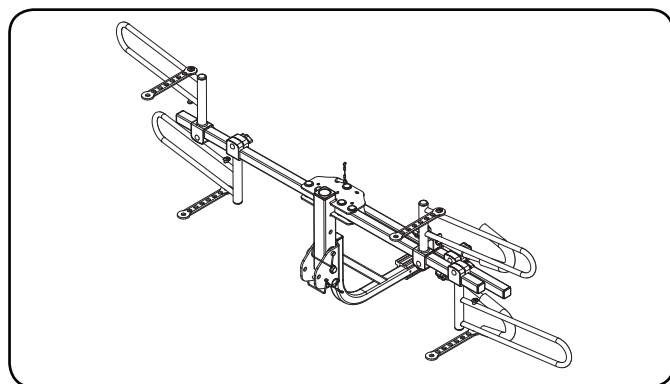
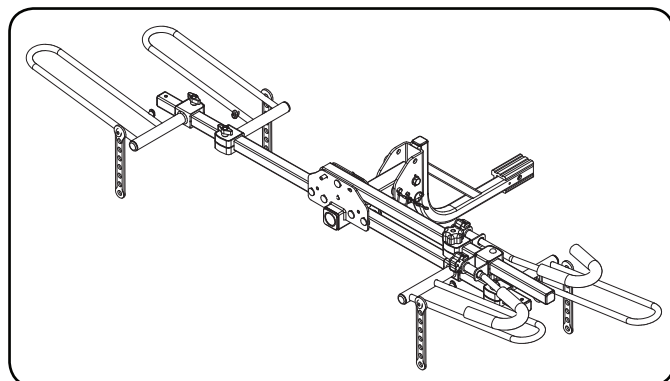
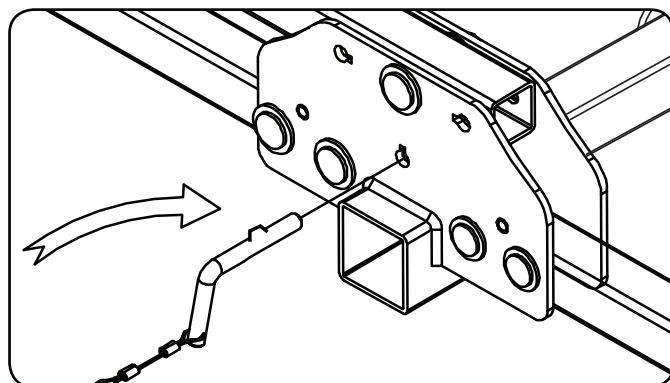

🗨 NOTE

The bike carrier can be put in the upright position with the secondary (3-4) bike carrier attachment installed.

This Page Intentionally Left Blank.

SPECIFICATIONS

Parts Diagram

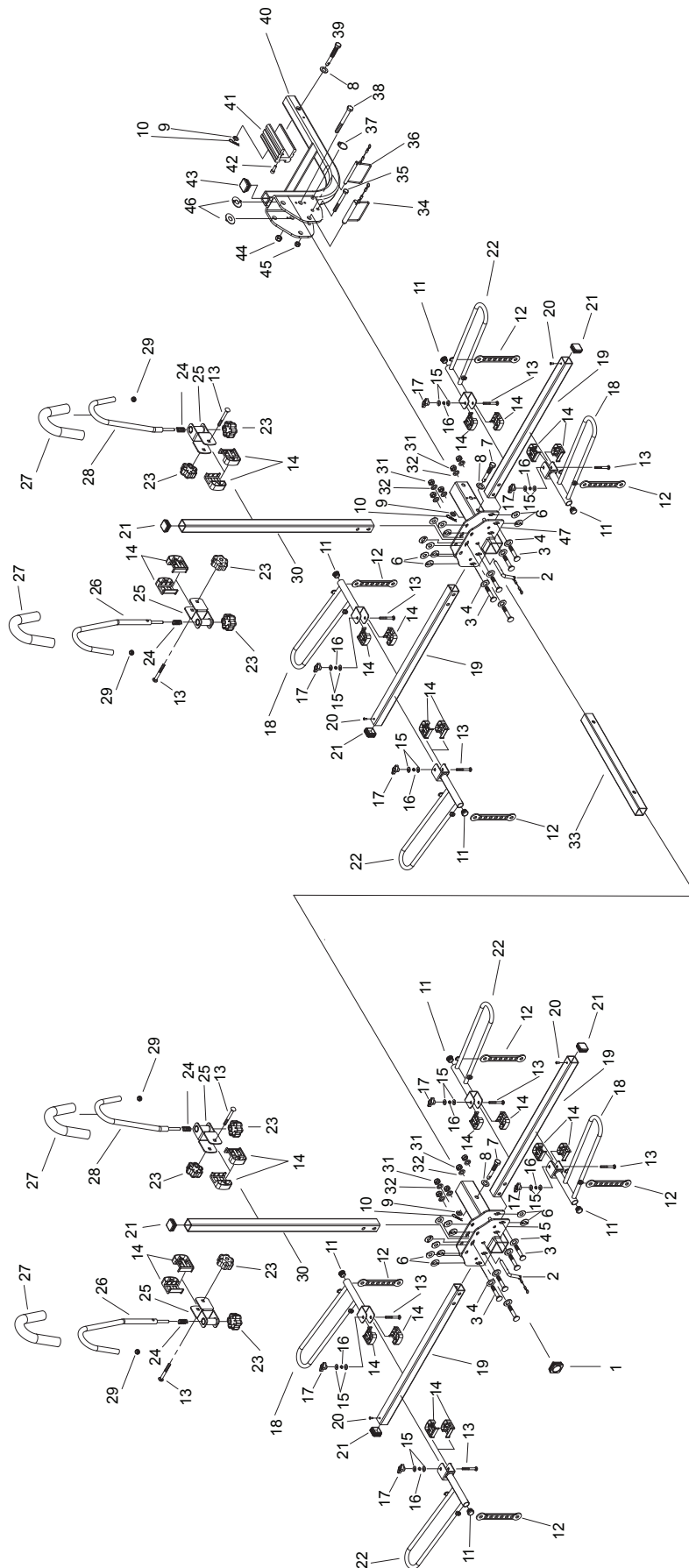

#	Part Number	Description	Qty
1	100189-17	REFLECTOR	2
2	100189-13	PIN Ø9	2
3	GB/T12-85 (M10 x 60)	CAP SCREW M10 x 60 mm	10
4	GB/T97-2000 (Ø15 x Ø28)	FLAT WASHER Ø15 x Ø28 mm	10
5	100189-03A	SUPPORT BASE-REAR	1
6	100189-16	PLASTIC SPACER Ø15 x Ø28	20
7	100189-11	SCREW M12 x 70 mm WITH END HOLE	2
8	GB/T97-2000 (Ø13)	FLAT WASHER Ø13 mm	3
9	GB/T97-2000 (Ø10 x 2)	FLAT WASHER Ø10 x 2 mm	3
10	100189-19	R PIN	3
11	100189-06.2	ROUND PLUG Ø28 mm	8
12	100189-12	STRAP	8
13	GB/T12-85 (M8 x 70)	CAP SCREW M8 x 70 mm	12
14	100189-06.4	PLASTIC ADAPTOR	24
15	GB/T97-2000 (Ø8)	FLAT WASHER Ø8 mm	16
16	GB/T93-1987 (Ø8)	SPRING WASHER Ø8 mm	12
17	100189-06.5	SMALL WING NUT	8
18	100189-07.1	LEFT SUPPORT ARM	4
19	100189-05.1	HORIZONTAL TUBE	4
20	GB/T1818-2000 (M6 x 10)	SCREW M6 x 10 mm	4
21	100189-04.2	SQUARE PLUG, 32 x 32 mm, EDGE 2.5 mm	6
22	100189-06.1	RIGHT SUPPORT ARM	4
23	100189-18	BIG WING NUT	8

#	Part Number	Description	Qty
24	100189-08.2	SPRING	4
25	100189-08.3	HOOK BASE	4
26	100189-08.1	LONG HOOK	2
27	100189-08.5	HOOK SLEEVE	4
28	100189-09.1	SHORT HOOK	2
29	100189-08.4	ROUND PLUG Ø16 mm	4
30	100189-04.1	VERTICAL TUBE	2
31	GB889-86 (M10)	LOCK NUT M10	10
32	GB/T97-2000 (Ø10)	FLAT WASHER Ø10 mm	10
33	100189-10	EXTENSION TUBE	1
34	100189-01.2	PIN Ø8 x 85 mm	1
35	10189-01.6	SCREW M8 x 75 mm	1
36	100189-01.3	PIN Ø12.6 x 8 mm	1
37	100189-01.4	RING	1
38	100189-14	SCREW M12 x 80 mm	1
39	100189-02	SCREW M12 x 95 mm WITH END HOLE	1
40	100189-1.1	HITCH MOUNTING SHANK	1
41	100189-01.5	2 in. RECEIVER ADAPTOR	1
42	GB5782-2000 (M6 x 18)	HEX SOCKET SCREW M6 x 18 mm	1
43	100189-01.7	SQUARE PLUG, 32 x 32 mm, EDGE 4.5 mm	1
44	GB889-86 (M12)	LOCK NUT M12	1
45	GB889-86 (M8)	LOCK NUT M8	1
46	100189-15	PLASTIC SPACER Ø15 x Ø36 mm	4
47	100189-03B	SUPPORT BASE-FRONT	1

WARRANTY

WARRANTY

CHAMPION POWER EQUIPMENT
2 YEAR LIMITED WARRANTY

Warranty Qualifications

Champion Power Equipment (CPE) will register this warranty upon receipt of your Warranty Registration Card and a copy of your sales receipt from one of CPE's retail locations as proof of purchase. Please submit your warranty registration and your proof of purchase within ten (10) days of the date of purchase.

Repair/Replacement Warranty

CPE warrants to the original purchaser that the mechanical and electrical components will be free of defects in material and workmanship for a period of two years (parts and labor) from the original date of purchase and 180 days (parts and labor) for commercial and industrial use). Transportation charges on product submitted for repair or replacement under this warranty are the sole responsibility of the purchaser. This warranty only applies to the original purchaser and is not transferable.

Do Not Return The Unit To The Place Of Purchase

Contact CPE's Technical Service and CPE will troubleshoot any issue via phone or e-mail. If the problem is not corrected by this method, CPE will, at its option, authorize evaluation, repair or replacement of the defective part or component at a CPE Service Center. CPE will provide you with a case number for warranty service. Please keep it for future reference. Repairs or replacements without prior authorization, or at an unauthorized repair facility, will not be covered by this warranty.

Warranty Exclusions

This warranty does not cover the following repairs and equipment:

Normal Wear

Products with mechanical and electrical components need periodic parts and service to perform well. This warranty does not cover repair when normal use has exhausted the life of a part or the equipment as a whole.

Installation, Use and Maintenance

This warranty will not apply to parts and/or labor if the product is deemed to have been misused, neglected, involved in an accident, abused, loaded beyond the product's limits, modified, installed improperly or connected incorrectly to any electrical component. Normal maintenance is not covered by this warranty and is not required to be performed at a facility or by a person authorized by CPE.

Other Exclusions

This warranty excludes:

- Cosmetic defects such as paint, decals, etc.
- Wear items such as filter elements, o-rings, etc.
- Accessory parts such as starting batteries, and storage covers.
- Failures due to acts of God and other force majeure events beyond the manufacturer's control.
- Problems caused by parts that are not original Champion Power Equipment parts.

Limits of Implied Warranty and Consequential Damage

Champion Power Equipment disclaims any obligation to cover any loss of time, use of this product, freight, or any incidental or consequential claim by anyone from using this product. THIS WARRANTY IS IN LIEU OF ALL OTHER WARRANTIES, EXPRESS OR IMPLIED, INCLUDING WARRANTIES OF MERCHANTABILITY OR FITNESS FOR A PARTICULAR PURPOSE.

A unit provided as an exchange will be subject to the warranty of the original unit. The length of the warranty governing the exchanged unit will remain calculated by reference to the purchase date of the original unit.

This warranty gives you certain legal rights which may change from state to state or province to province. Your state or province may also have other rights you may be entitled to that are not listed within this warranty.

Contact Information

Address

Champion Power Equipment, Inc.
Customer Service
12039 Smith Ave.
Santa Fe Springs, CA 90670 USA
www.championpowerequipment.com

Customer Service

Mon – Fri 8:30 AM – 5:00 PM (PST/PDT)
Toll Free: 1-877-338-0999
info@championpowerequipment.com
Fax no.: 1-562-236-9429

Technical Service

Mon – Fri 8:30 AM – 5:00 PM (PST/PDT)
Toll Free: 1-877-338-0999
tech@championpowerequipment.com
24/7 Tech Support: 1-562-204-1188